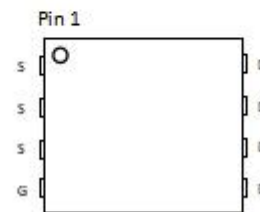

isc N-Channel MOSFET Transistor
BSC350N20NSFD
DESCRIPTION

- Drain Source Voltage- $V_{DSS}=200V(\text{Min})$
- Fast Switching Speed
- 100% avalanche tested
- Minimum Lot-to-Lot variations for robust device performance and reliable operation

APPLICATIONS

- Synchronous Rectification in SMPS
- Hard Switching and High Speed Circuit
- Power Tools
- Motor Control

ABSOLUTE MAXIMUM RATINGS($T_a=25^\circ\text{C}$)

SYMBOL	PARAMETER	VALUE	UNIT
V_{DSS}	Drain-Source Voltage ($V_{GS}=0$)	200	V
V_{GS}	Gate-Source Voltage	± 20	V
I_D	Drain Current-continuous@ $T_c=25^\circ\text{C}$	35	A
I_{DM}	Drain Current-Single Pulse	140	A
P_D	Power Dissipation@ $T_c=25^\circ\text{C}$	150	W
E_{AS}	Repetitive avalanche energy	100	mJ
T_j	Max. Operating Junction Temperature	175	$^\circ\text{C}$
T_{stg}	Storage Temperature Range	-55~175	$^\circ\text{C}$

THERMAL CHARACTERISTICS

SYMBOL	PARAMETER	MAX	UNIT
$R_{th\ j-c}$	Thermal Resistance,Junction to Case	1	$^\circ\text{C}/\text{W}$
$R_{th\ j-A}$	Thermal Resistance,Junction to Ambient	50	$^\circ\text{C}/\text{W}$

isc N-Channel MOSFET Transistor
BSC350N20NSFD
• ELECTRICAL CHARACTERISTICS (T_c=25°C)

SYMBOL	PARAMETER	CONDITIONS	MIN	TYP.	MAX	UNIT
V _{(BR)DSS}	Drain-Source Breakdown Voltage	V _{GS} =0; I _D = 250uA	200	--	--	V
V _{GS(TH)}	Gate Threshold Voltage	V _{DS} =V _{GS} , I _D = 90uA	2	--	4	V
R _{DS(ON)}	Drain-Source On-stage Resistance	V _{GS} = 10V; I _D = 35A	--	--	35	mΩ
I _{GSS}	Gate Source Leakage Current	V _{GS} = ±20V; V _{DS} = 0	--	--	±100	nA
I _{DSS}	Zero Gate Voltage Drain Current	V _{DS} = 160V; V _{GS} = 0	--	--	1	μA
V _{SD}	Source to Drain Diode Forward Voltage	V _{GS} = 0 V, I _F = 35 A	--	--	1.2	V

PACKAGE OUTLINE

Dimensions in mm (1mm = 0.0394")

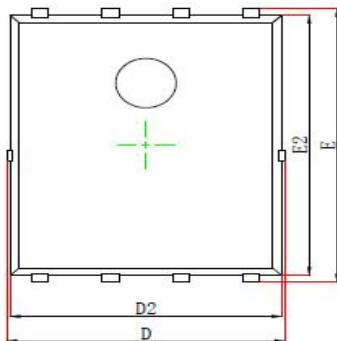
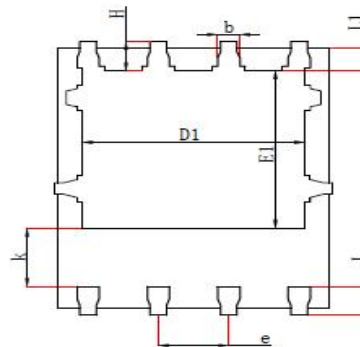
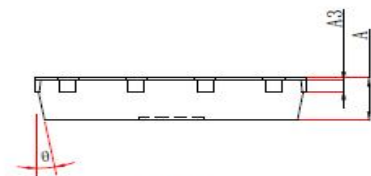
 Top View
 [顶视图]

 Bottom View
 [背视图]

 Side View
 [侧视图]

Symbol	Dimensions In Millimeters		Dimensions In Inches	
	Min	Max	Min	Max
A	0.900	1.100	0.035	0.043
A3	0.254 REF		0.010REF	
D	4.680	5.120	0.184	0.202
E	5.900	6.126	0.232	0.241
D1	3.610	4.110	0.142	0.162
E1	3.380	3.780	0.133	0.149
D2	4.800	5.000	0.189	0.197
E2	5.674	5.826	0.223	0.229
k	1.100	1.390	0.043	0.055
b	0.330	0.510	0.013	0.020
e	1.270TYP		1.270TYP	
L	0.510	0.711	0.020	0.028
L1	0.424	0.576	0.017	0.023
H	0.410	0.726	0.016	0.029
θ	0°	12°	0°	12°

NOTICE:

ISC reserves the rights to make changes of the content herein the datasheet at any time without notification. The information contained herein is presented only as a guide for the applications of our products.

ISC products are intended for usage in general electronic equipment. The products are not designed for use in equipment which require specialized quality and/or reliability, or in equipment which could have applications in hazardous environments, aerospace industry, or medical field. Please contact us if you intend our products to be used in these special applications.

ISC makes no warranty or guarantee regarding the suitability of its products for any particular purpose, nor does ISC assume any liability arising from the application or use of any products, and specifically disclaims any and all liability, including without limitation special, consequential or incidental damages.